

# FITTING INSTRUCTIONS



*Landau*

# INSTALLING BROOKLANDS FRAME WITH BUTT HINGES



1 Check contents of pack are correct.



2 Be careful not to cause damage to contents with sharp implements.



3 Remove Brooklands frame, door, fixing bars and fittings pack.

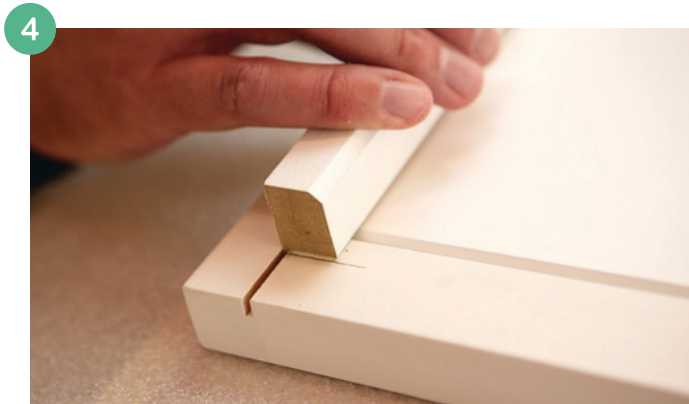

4 Place frame face down on a protected surface. Mark required position of fixing bars (normally carcass thickness down from top of frame).



5 Adhere the fixing bars to the frame with PVA glue.



6 Once the adhesive has dried, position the frame against the carcass. The bars should rest on the bottom shelf for ease of installation. Protect the frame and use a clamp to hold against the carcass.



7 Pilot hole through the predefined holes in the fixing bars into the carcass.



8 Using a fixed handle screwdriver, screw the fixing bars with the 3.5x30mm flat head screws provided (this avoids over tightening and will not put strain on the frame).

# INSTALLING BROOKLANDS FRAMES USING CONCEALED HINGES

When using concealed hinges, one fixing bar will have notches to allow for the arm of the hinge to pass over.

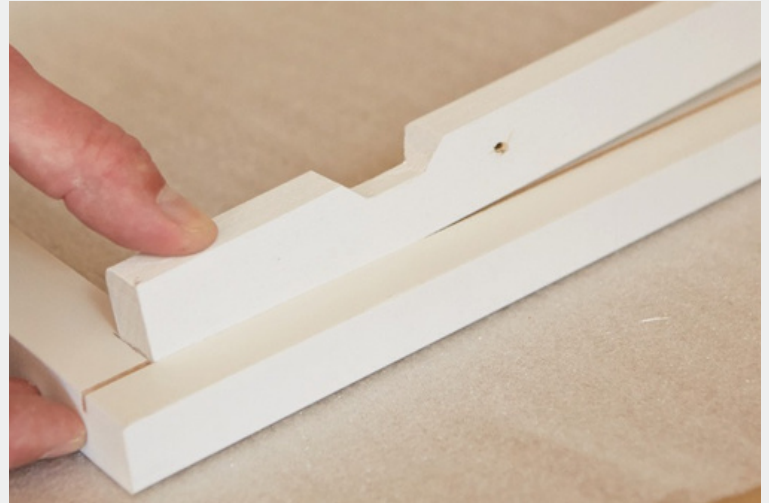

Fix hinges to door and "clip" to hinge plate. Adjust door alignment on concealed hinges if required.

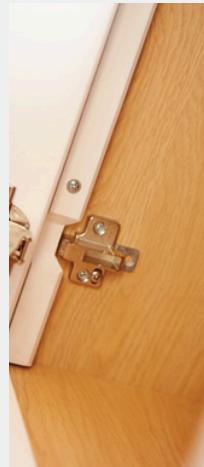

## **Self closing cranked hinge:**

Blum 110 deg clip top Blumotion hinge Blum code: 71B3750

Landau code: ACCHINGE71B3750

## **Mounting plate:**

Blum 9mm Cruciform mounting plate: Blum code: 175H7190

Landau code: ACCPLATE175H7190

*Landau*

# INSTALLING CONCEALED RUNNERS & OAK DRAWERS

All our drawers are compatible with Blum Tandem runners and can be adapted for other suppliers of concealed runners. **Always fit runners prior to installing Brooklands.**

1



Install runner to required position using Blum packers (or 18mm MFC packers)

2



Pilot hole drawer box for drawer front fixing.

3



On the underside of drawer, pilot hole for front connector clips.

4



Fix connector clips using 3.5mm x 15mm pan head pozi woodscrews.

5



Place drawer onto the runners and position the pin into the rear of drawer box and click into front connector.

6



Fix drawer front onto drawer box.

*Landau*